



INVL Series-Long Standby Life INVL12-150 (12V 150Ah)

INVERMEXA

Performance Characteristics

Nominal Voltage	12V
Number of cell	6
Design Life	10 years
Nominal Capacity 25°C	
• 10 hour rate (15.0A, 10.8V)	150.0Ah
• 5 hour rate (27.0A, 10.5V)	135.0Ah
• 1 hour rate (102A, 9.6V)	102.0Ah
Internal Resistance	
• Fully Charged Battery 25°C	<4.5mOhms
Self-Discharge	
• 3% of capacity declined per month at 20°C	
Operating Temperature Range	
• Discharge	-20~60°C
• Charge	-10~60°C
• Storage	-20~60°C
Max. Discharge Current 25°C	1000A (5s)
Short Circuit Current	2700A
Charge Methods: Constant Voltage Charge 25°C	
• Cycle use	2.40-2.45VPC
• Maximum Charging Current	45.0A
• Temperature compensation	-30mV/°C
• Standby use	2.20-2.30VPC
• Temperature compensation	-20mV/°C
Dimensions and Weight	
• Length (mm/inch)	482 / 18.98
• Width (mm/inch)	170 / 6.69
• Height (mm/inch)	240 / 9.45
• Total Height (mm/inch)	240 / 9.45
• Approx. Weight (Kg/lbs)*	48.4 / 106.7
*Weight deviation: ~5%	



Layout

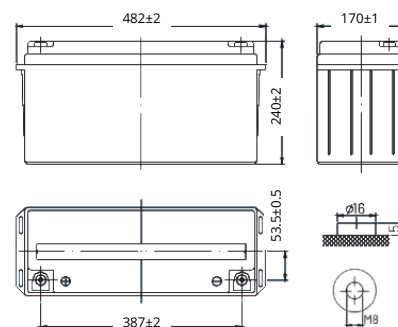

Discharge Constant Current (Amperes at 77°F 25°C)

End Point Volts/Cell	10min	15min	30min	45min	1h	3h	5h	10h
1.60V	360	288	169	123	102	44.5	28.8	15.5
1.65V	327	214	162	120	99.0	44.2	28.2	15.4
1.70V	313	210	160	118	96.3	43.8	27.6	15.2
1.75V	288	198	156	114	93.4	43.4	27.0	15.1
1.80V	264	186	150	110	90.5	41.4	26.5	15.0

Discharge Constant Power (Watts/cell at 77°F 25°C)

End Point Volts/Cell	10min	15min	30min	45min	1h	2h	3h	5h
1.60V	637	542	333	243	192	111	84.5	55.4
1.65V	614	504	304	235	186	109	83.9	54.1
1.70V	566	469	300	229	181	108	83.3	53.2
1.75V	532	444	294	224	177	106	82.1	52.1
1.80V	498	425	289	221	175	104	80.8	51.0



INVL Series-Long Standby Life INVL12-150 (12V 150Ah)

INVERMEXA

General features

- 12 years design life (25°C)
- Grid refining technology and the thicker plates are used to extend the battery standby life and reduce the plate grid corrosion speed.
- Using oxygen recombination technology: maintenance-free
- Unique vent valve design: control water losing, prevent air and spark going inside

Standards

- Compliance with IEC 60896 standards, EU Battery Directive.
- UL, CE Certified.
- Manufactured under ISO45001, ISO9001 and ISO14001 certified production facilities.

Applications

- UPS and EPS
- Emergency light
- Railway signal and aircraft signal system
- Marine and power stations
- Alarm and security system
- Electronic apparatus and equipment
- Communication power supply, DC power supply

